



Cotswold road, BA2 2DL

£1,175 PCM

To Let



- Modern and spacious layout
- Enclosed garden
- Unfurnished with white goods included
- Move in 12th June 2026
- Private entrance
- 0.6 miles from Moorland Road shops
- Council tax band B

THE PROPERTY

Modern apartment with private entrance, garden, and permit parking, available unfurnished and in good condition throughout.

COTSWOLD ROAD

A modern well proportioned apartment with private entrance and enclosed garden, offered unfurnished. Conveniently located, with bus stops nearby, as well as vibrant Moorland Road 0.6 miles away and central Bath less than 2 miles away.

You enter the apartment to a hallway with space for shoes and coats, with a flight of stairs leading up. The living room is a bright space open-plan with the kitchen, with laminated wooden flooring throughout. The kitchen is fitted with a breakfast bar, washing machine, built in fridge and freezer, and double oven.

The bedroom is large double including curtains and a feature wall. The bathroom has been fitted with a modern white suite of toilet, hand basin and bath with shower over.

The apartment benefits from a private, enclosed garden, which is part turfed & part decked. Parking is permit on street and plentiful nearby.

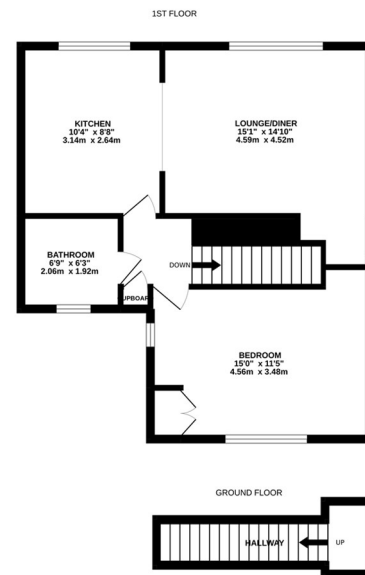

Whilst every attempt has been made to ensure the accuracy of the description contained herein, measurements of doors, windows, rooms and any other items are approximate and no responsibility is taken for any error, omission or misstatement. This plan is for illustrative purposes only and should be used as such by any prospective purchaser. The services, systems and appliances shown have not been tested and no guarantee as to their operability or efficiency can be given.
Made with Metropop ©2022